

Fast + Simple
Focused on Veterinary Diagnostics

FASTest[®] SARS-CoV-2 Ag_{ad us. vet.}

One Health – Diagnostics taking responsibility for human and animal health

Fast test for the qualitative detection of **SARS-CoV-2 antigens** in nasal and/or throat secretions of the cat

Fast aetiological diagnostics in nasal and/or throat secretions in the event of clinical suspicion

Testing of contact cats with SARS-CoV-2 positive owners

SARS-CoV-2 exclusion diagnostics if the test result is negative

FLI approval 07/2021 (German registration)



- Simple test procedure with nasal and/or throat secretions
- Fast test interpretation after 15 minutes
- Reliable clinical diagnostics
- Sensitivity 100% & Specificity 90.47%
- Storage at room temperature (15–25°C)
- Long shelf life
- Compact test box with 2 or 5 tests

... **FASTest[®] SARS-CoV-2 Ag** ad us. vet.

SARS-CoV-2 belongs to the group of β -coronaviruses and causes COVID-19 in humans. Individual transmissions to the cat are reported. However, transmission from cats to humans has not yet been confirmed. Until this is finally clarified, a potential risk of transmission can be assumed (risk of zoonosis). In accordance with the World Organisation for Animal Health (WOAH), the risk of transmission from susceptible pets to humans is considered low (source: FLI 04/2020).

By testing antigen in nasal or throat secretions, more infected animals can be identified: The antigen detection can be positive shortly after the incubation phase (2–14 days, \emptyset 5 days*) if IgG cannot yet be detected. This means that infected animals can be isolated at an early stage.

The present test provides valuable information about a possible infection of cats with SARS-CoV-2. However, it can only be used for the detection of SARS-CoV-2 antigens in nasal and/or throat swabs. Clarification of a positive test result by RT-PCR is always necessary to determine an infection. In Germany, due to reporting requirements if positive results occur, clarification by the National Reference Laboratory for SARS-CoV-2 infections in domestic animals at the Friedrich-Loeffler-Institute, Riems Island, is mandatory. Please check the requirements of your country!

Based on specific monoclonal antibodies, the **FASTest[®] SARS-CoV-2 Ag** is an important diagnostic tool for the clarification of clinical suspected SARS-CoV-2 cases in cats.

The Feline Coronavirus (FCoV) belongs to the group of α -coronaviruses and has no serological cross-reactivity to SARS-CoV-2.

Test procedure

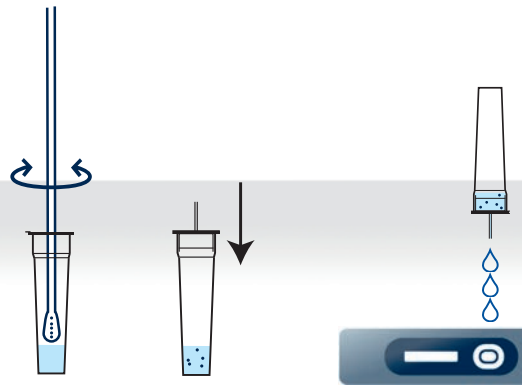

Test interpretation



POSITIVE



NEGATIVE



Due to the obligation to notify, a clarification by the National Reference Laboratory for SARS-CoV-2 infections in kept animals is mandatory if positive results occur.

* Source: https://www.woah.org/fileadmin/Home/eng/Our_scientific_expertise/docs/pdf/COV-19/A_Factsheet_SARS-CoV-2.pdf

EN 07-2022



Distribution: