

Fast + Simple  
Focused on Veterinary Diagnostics

# FASTest® CRYPTO-ROTA D2T ad us. vet.

## Common diarrhoea pathogens with zoonotic potential

Fast test for the qualitative detection of **Cryptosporidium spp.** and **Rotavirus** antigens in feces of pocket pets, pets and farm animals

Fast aetiological diagnostics

Fast specific therapy (especially Cryptosporidia)

Fast, long-term and effective prophylaxis

- > Breeding stock: Health check
- > Problem stock: Stock control

Effective reduction of medical costs/economic damage



- Simple and hygienic test procedure with feces
- Innovative test system and reliable pathogen detection
- Parallel incubation of both test membranes using the same buffer diluent
- Fast test interpretation within 5 minutes

	Sensitivity	Specificity
■ C. spp.	94.1 %	95.5 %
■ Rotavirus	96 %	100 %

- Storage at room temperature (15–25 °C)
- Long shelf life
- Compact test box with 10 tests

# FASTest<sup>®</sup> CRYPTO-ROTA D2T ad us. vet.

Diarrhoea can lead to severe courses of disease up to death for all species. Among the diverse diarrhoea pathogens in pocket pets, pets and farm animals, especially *Cryptosporidium parvum* and Rotavirus are a great challenge for the veterinarian due to their common appearance and their zoonotic potential.

Especially in cattle population, Rotavirus is widely spread (seroprevalence up to 100%). Recent studies in Germany with small animals have shown prevalences in dogs and cats of 7% and 8%, respectively.

Cryptosporidia form two types of infectious oocysts: 20% are thin-walled and stay in the host, where they cause reinfection through autoinfection. The remaining 80% are thick-walled and are excreted intermittently, i.e. not with every defecation, as dormancy stages. These are very resistant and can remain infectious for months. They can infect other animals as well as humans via drinking water.

Clinical symptoms can vary depending on age and immune status of the animal. Neonates and young animals are predominantly affected. Caused by the high infectiveness, often a population problem arises. Double infections are not uncommon. Special attention should be paid in the fact that Cryptosporidia as well as Rotavirus play important roles independent of the diarrhoea problem (asymptomatic shedders).

Therefore, **FASTest<sup>®</sup> CRYPTO-ROTA D2T** enables the veterinarian to prove both pathogens early, specifically and on-site in pocket pets, pets and farm animals and therefore to introduce specific therapy, hygiene and prevention measures immediately.

## Test procedure

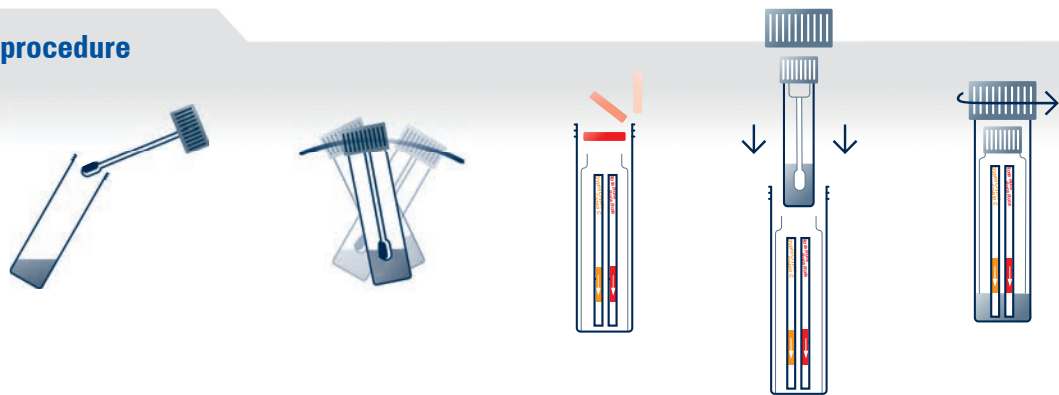

## Test interpretation



POSITIVE



NEGATIVE



Cryptosporidia often come up accompanied with other diarrhoea pathogens (Rota and Corona viruses, *E. coli*, *Giardia duodenalis*, *Tritrichomonas foetus* and others). Therefore, for diarrhoea symptoms in farm animals, it is generally advisable to use the parallel tests **FASTest<sup>®</sup> BCV** Strip, **FASTest<sup>®</sup> CRYPTO** Strip, **FASTest<sup>®</sup> GIARDIA** Strip, **FASTest<sup>®</sup> CRYPTO-GIARDIA** Strip, **FASTest<sup>®</sup> ROTA** Strip or the combined test **FASTest<sup>®</sup> D4T** bovine.

In pocket pets and pets with diarrhoea, following tests are recommended: **FASTest<sup>®</sup> GIARDIA** Strip (dog, cat), **FASTest<sup>®</sup> CCoV** Strip (dog), **FASTest<sup>®</sup> PARVO** Strip (dog, cat), **InPouch<sup>™</sup> TF-Feline** (cat).

EN 07-2025



Distribution: